

ELEVATION

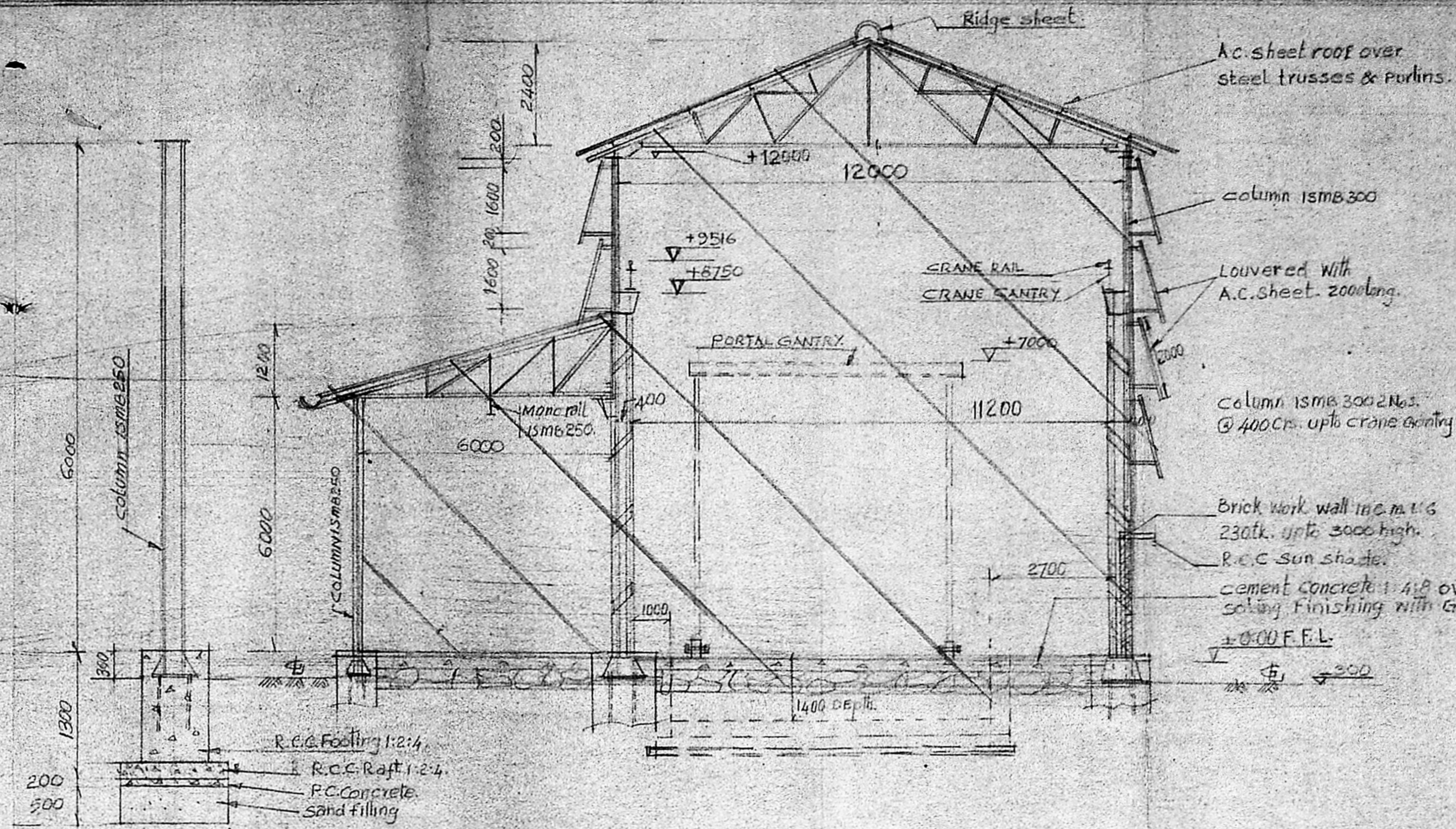

SECTIONAL ELEVATION

SECTION - AA

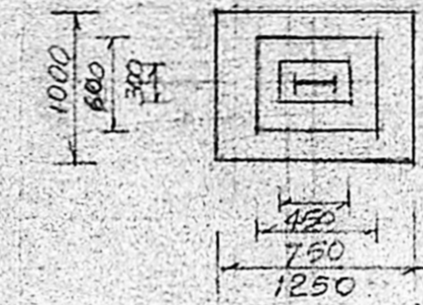

PLAN OF FOUNDATION  
DETAILS OF COLUMN FOUNDATION  
FOR LEAN TO ROOF

SIDCO PLOT 826 SIDCO PLOT 816

Planning Permt. No. C.L.P.P./16/17/70  
**APPROVED**  
SUBJECT TO THE CONDITIONS IN THIS OFFICE LETTER  
No. C2/20591/89 Dated 2.9.90  
FOR MEMBER SECRETARY  
MADRAS METROPOLITAN  
DEVELOPMENT AUTHORITY  
MADRAS - 600 008

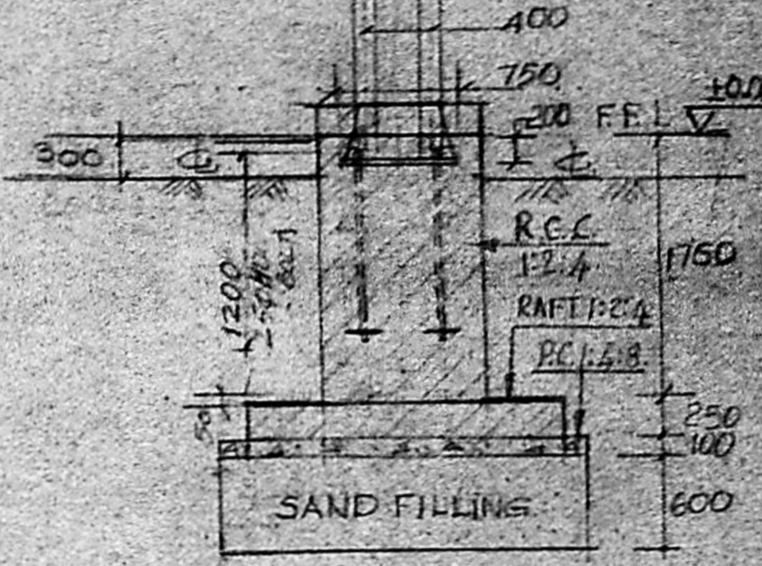

SECTIONAL ELEVATION

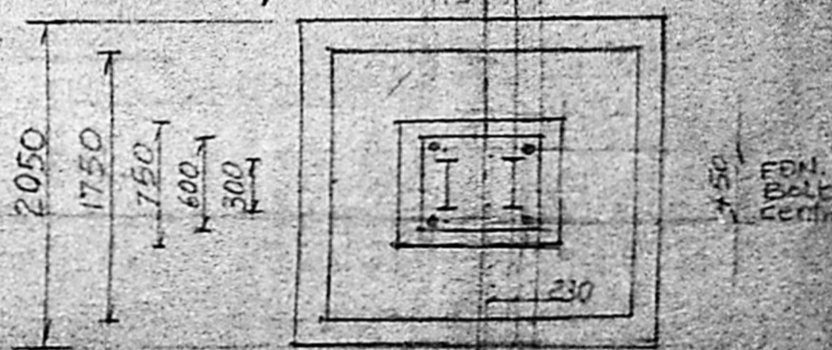

PLAN OF FOUNDATION

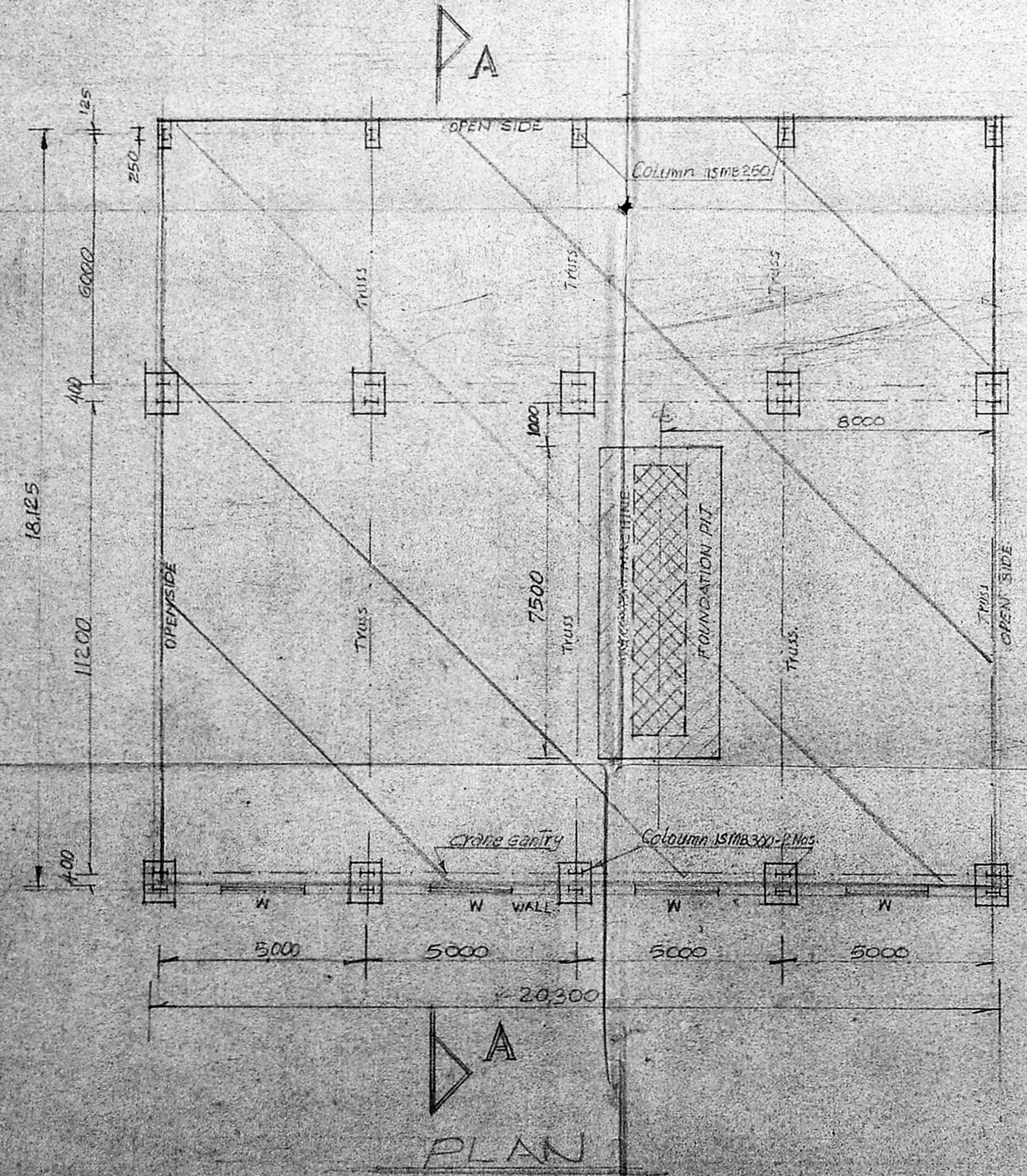

PLAN

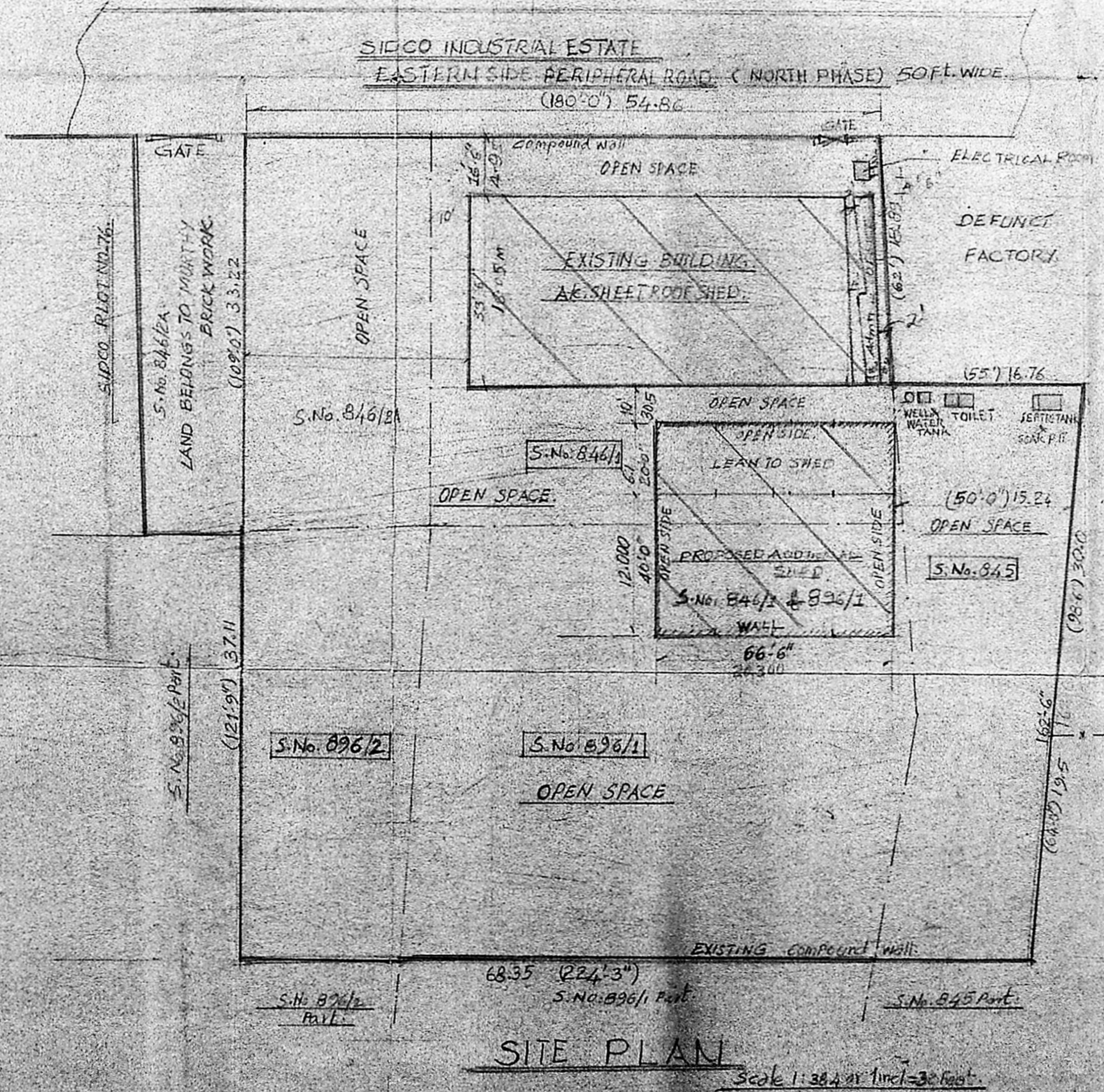

SITE PLAN

Scale 1:38.4 or 1 inch = 38.4 feet

REFERENCE

FOUNDATION - 2050 below G.L. 100% mass concrete  
1.4:1.6:2.00 R.C.C. RAFT 1:2:4  
Pillars above raft & Plinth Beam 100% cast in situ  
FOR WALLS - Above plinth beam 350x400 depth  
SUPER STRUCTURE - With R.S.T. Columns. Brick work in m.s. up to 300 high. 230th on one side only  
ROOFING - With A.C. Sheet over steel trusses & purlins  
CONCRETE - 1:2:4 mix using 20mm diameter metal. For Plinth Beam and lintel sun shade.  
FLOORING - Granolithic flooring using 1:3:6 concrete over 30mm soling with boulders 3. Finishing with chips 12mm 1:1/2 3 mix.

SITE AREA - 4584.559 mt (or) (20G. 1370 sq.ft)  
EX. Building Plinth Area - 512.9 m<sup>2</sup> (5521.59 sq.ft)  
PRO. BUILDING PLINTH AREA - 367.95 sq.mt. (3960.5 sq.ft)  
F.S.I. - 0.19 PLOT COVERAGE - 19%

SCHEDULE OF JOINERIES

w - steel Glazed window - 2000x1800 high  
w - steel Glazed window - 2000x1800 high

PROPOSED ADDITIONAL SHED IN S.No. 846/1 & 896/1 OF KORATTUR VILLAGE  
44 & 45, SIDCO INDUSTRIAL ESTATE, AMBATTUR TOWNSHIP, MADRAS - 60

- PROPOSED
- ROADS
- EXISTING
- BOUNDRY

For D. B. THE ENGINEER & ARCHT. ETC.  
D. B. THE ENGINEER & ARCHT. ETC.  
OWNER

M. SANKARANARAYANAN  
LICENSED SURVEYOR  
AMBATTUR & AVADI TOWNSHIP  
6-000V CONST. LOTIONS  
22-A, M.S.P.O. ROAD  
AMBATTUR, MADRAS-600053